

**Machines Covered**

This Covers the CLE line of dishwashers including: CL44e, CL54e, (STD & HTS) and CL64e STD

The below information was taken from and can be found within the instruction manual of any Hobart product, located at: <https://www.hobartcorp.com/resources-hobart>.



**⚠️WARNING** Disconnect the electrical power to the machine and follow lockout / tagout procedures. There may be multiple circuits. Be sure all circuits are disconnected.

**⚠️WARNING** When performing service work, corrosive chemicals may be present. Exposure to these chemicals could result in injury. It is very important to follow the manufacturer's instructions as found in the (Material) Safety Data Sheet/(M) SDS. Information regarding the Personal Protective Equipment (PPE) requirements can be found in the (M) SDS that accompanies product or can be found online.

**Fill/Rinse System**

✓ = PROCESS COMPLETED

Task	Part	Qty	Comments	<input type="checkbox"/>
A: Replace vacuum breaker kit.	00-292910	1	---	<input type="checkbox"/>
B: Clean rinse arms and replace O-Rings.	00-067500-00007	4	---	<input type="checkbox"/>
C: Replace rinse arm strainers.	00-936197	2	---	<input type="checkbox"/>
D: Replace final rinse nozzles.	00-893535	11	---	<input type="checkbox"/>

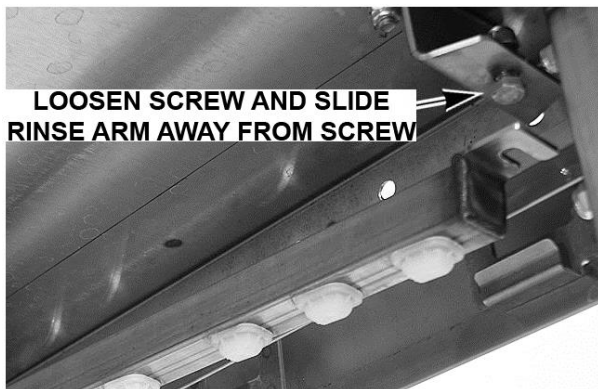
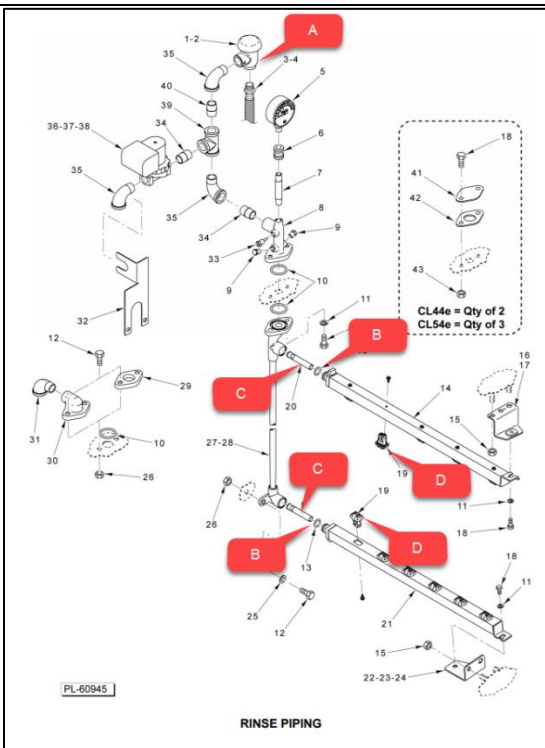

**Drain System**

✓ = PROCESS COMPLETED

Task	Part	Qty	Comments	<input type="checkbox"/>
A: Replace fill floats.	00-122674	2	CL44e & CL54e Only	<input type="checkbox"/>
		4	CL64e Only	<input type="checkbox"/>
		3	CL44e & CL54e HTS Only	<input type="checkbox"/>
B: Replace standpipe O-ring	00-067500-00120	5	---	<input type="checkbox"/>

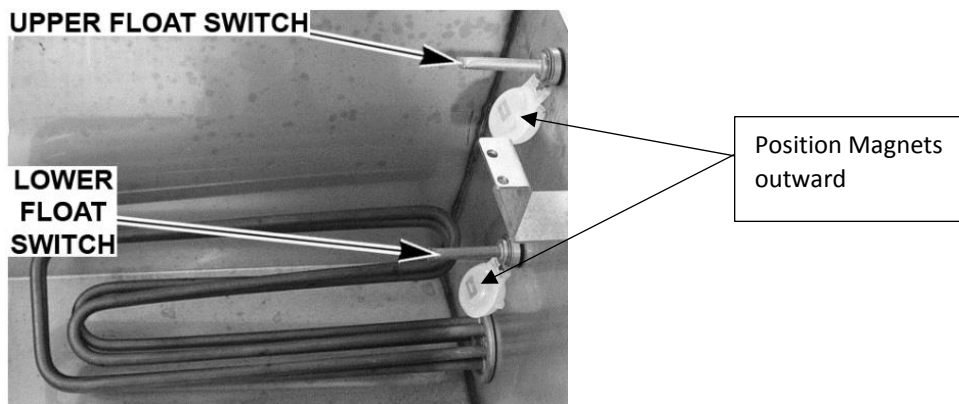
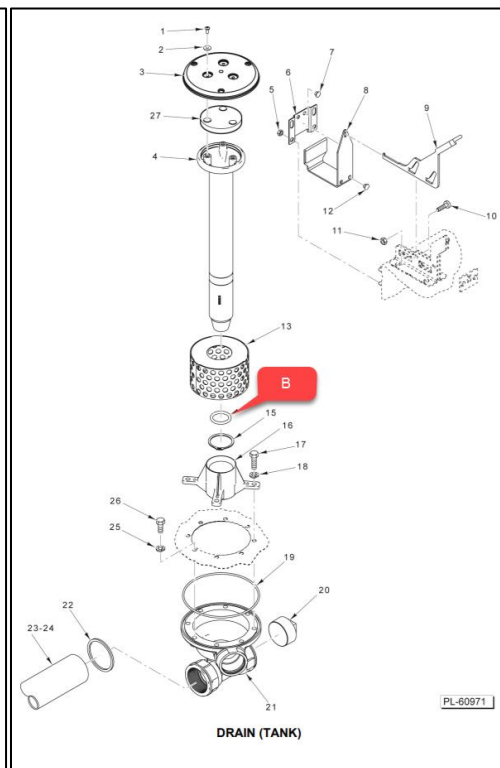
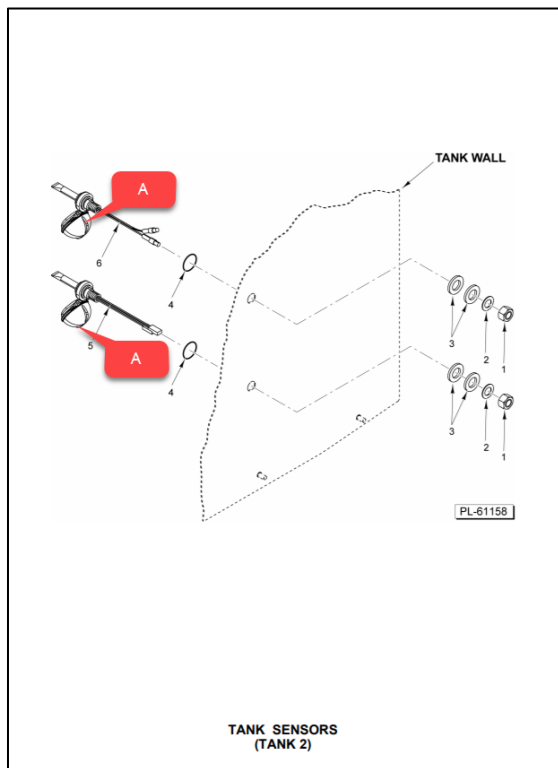

**Wash Tank/Rinse Tank System**

✓ = PROCESS COMPLETED

Task	Part	Qty	Comments	<input type="checkbox"/>
A: Replace upper and lower wash arm end caps.	00-919363	10	CL44e & CL54e Only	<input type="checkbox"/>
		14	CL44e & CL54e HTS Only	<input type="checkbox"/>
		12	CL64e Only	<input type="checkbox"/>
B: Replace upper and lower wash arm manifold O-ring.	00-067500-00014	4	---	<input type="checkbox"/>

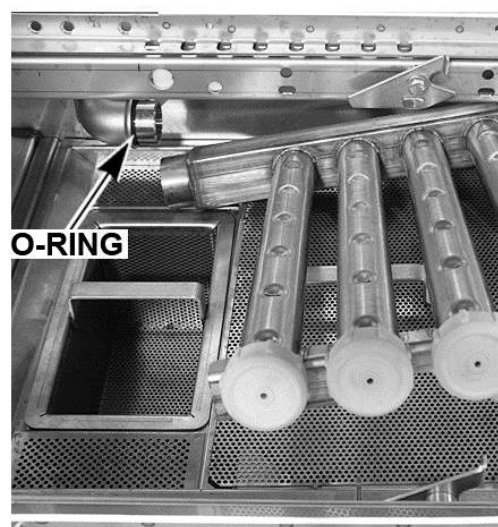
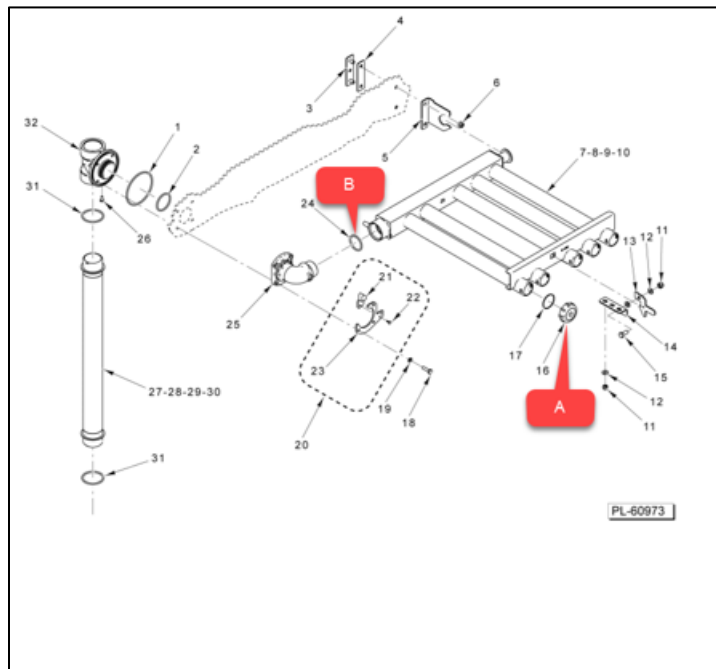

**Curtains (CLeN)**

✓ = PROCESS COMPLETED

Task	Part	Qty	Comments	<input type="checkbox"/>
Replace curtains.	---	---	---	<input type="checkbox"/>
L: Curtain, Splash, 4-Ply (STD)	00-919758	2	---	<input type="checkbox"/>
L: Curtain, Splash, 4-Ply (HTS)	00-919975	2	CL44e & CL54e HTS Only	<input type="checkbox"/>
S: Curtain, Splash (Short)	00-919509	1	---	<input type="checkbox"/>
CO: Curtain (Carry Over)	00-936922	1	CL64e Only	<input type="checkbox"/>
M: Curtain, Wash, 3-Ply (STD)	00-936428	1	CL64e Only	<input type="checkbox"/>

**CL44eN, CL54eN  
CL44eNER, CL54eNER  
CL44eNADV, CL54eNADV**

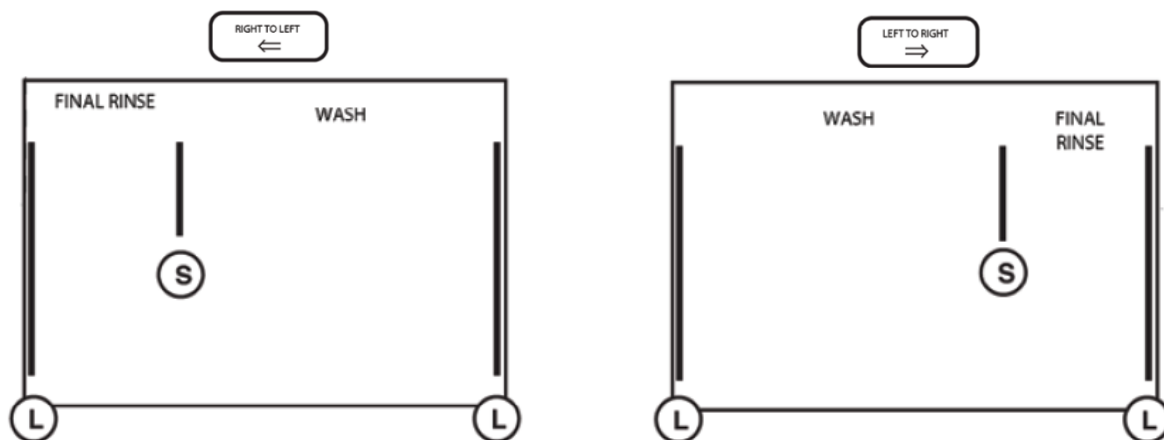

**CL64eN  
CL64eNER  
CL64eNADV**

