

Machines Covered

This Covers the CA line of dishwashers including: C44A, C54A & C64A

The below information was taken from and can be found within the instruction manual of any Hobart product, located at: <https://www.hobartcorp.com/resources-hobart>.



⚠️WARNING Disconnect the electrical power to the machine and follow lockout / tagout procedures. There may be multiple circuits. Be sure all circuits are disconnected.

⚠️WARNING When performing service work, corrosive chemicals may be present. Exposure to these chemicals could result in injury. It is very important to follow the manufacturer's instructions as found in the (Material) Safety Data Sheet/(M) SDS. Information regarding the Personal Protective Equipment (PPE) requirements can be found in the (M) SDS that accompanies product or can be found online.

Wash Tank/Rinse Tank System

✓ = PROCESS COMPLETED

Task	Part	Qty	Comments	<input type="checkbox"/>
A: Replace O-Ring.	00-067500-00110	3	C44A & CL54A Only	<input type="checkbox"/>
		6	C64A Only	<input type="checkbox"/>
B: Replace O-Ring.	00-067500-00127	10	---	<input type="checkbox"/>
		20	C64A Only	<input type="checkbox"/>

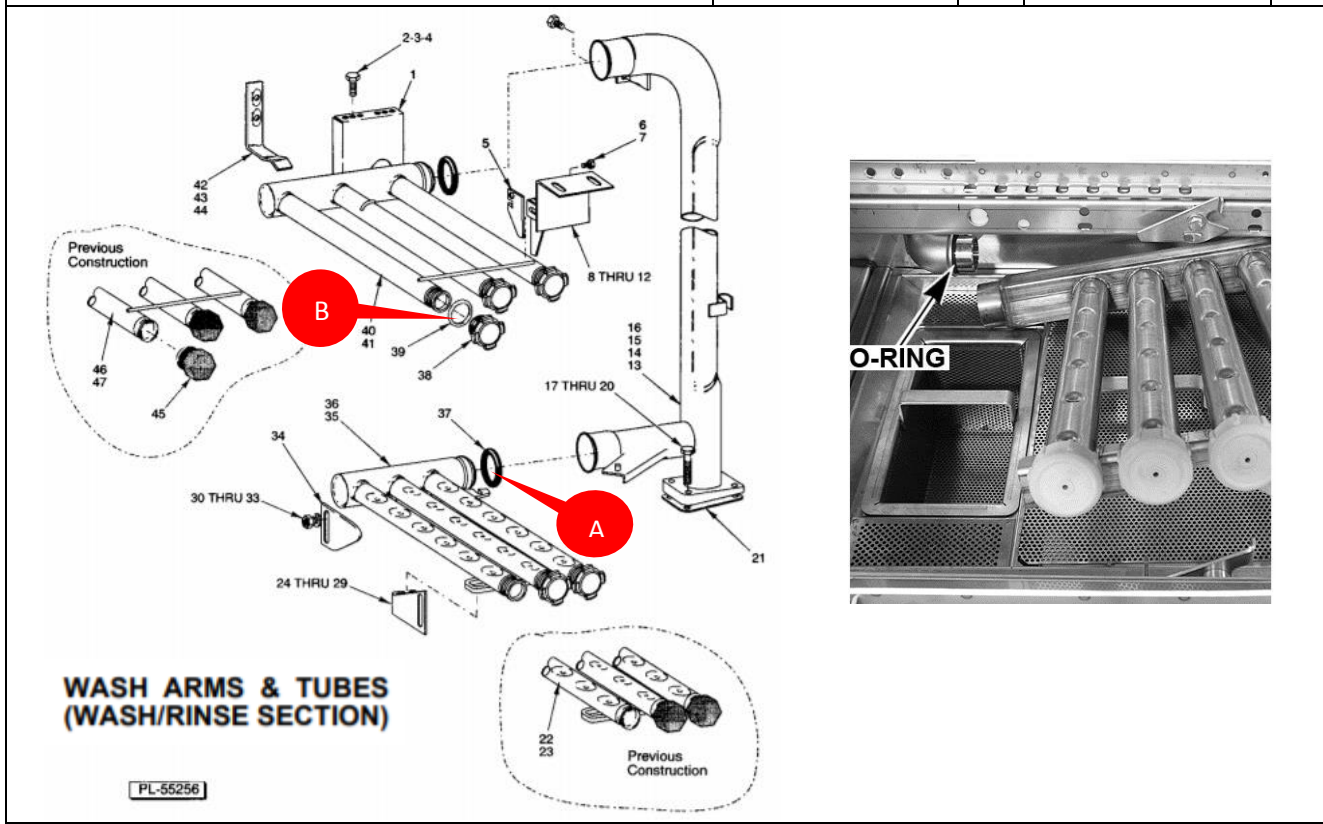

Fill/Rinse System

✓ = **PROCESS COMPLETED**

Task	Part	Qty	Comments	<input type="checkbox"/>
A: Replace vacuum breaker kit.	00-118270	1	Not Used For C64A	<input type="checkbox"/>
A: Replace vacuum breaker kit.	00-274233	1	Not Used For C64A	<input type="checkbox"/>
A: Replace vacuum breaker kit.	00-292910	1	---	<input type="checkbox"/>
		2	C64A Only	<input type="checkbox"/>
B: Clean rinse arms and replace O-Rings.	00-067500-00007	4	---	<input type="checkbox"/>
C: Replace final rinse nozzles.	00-893535	11	---	<input type="checkbox"/>

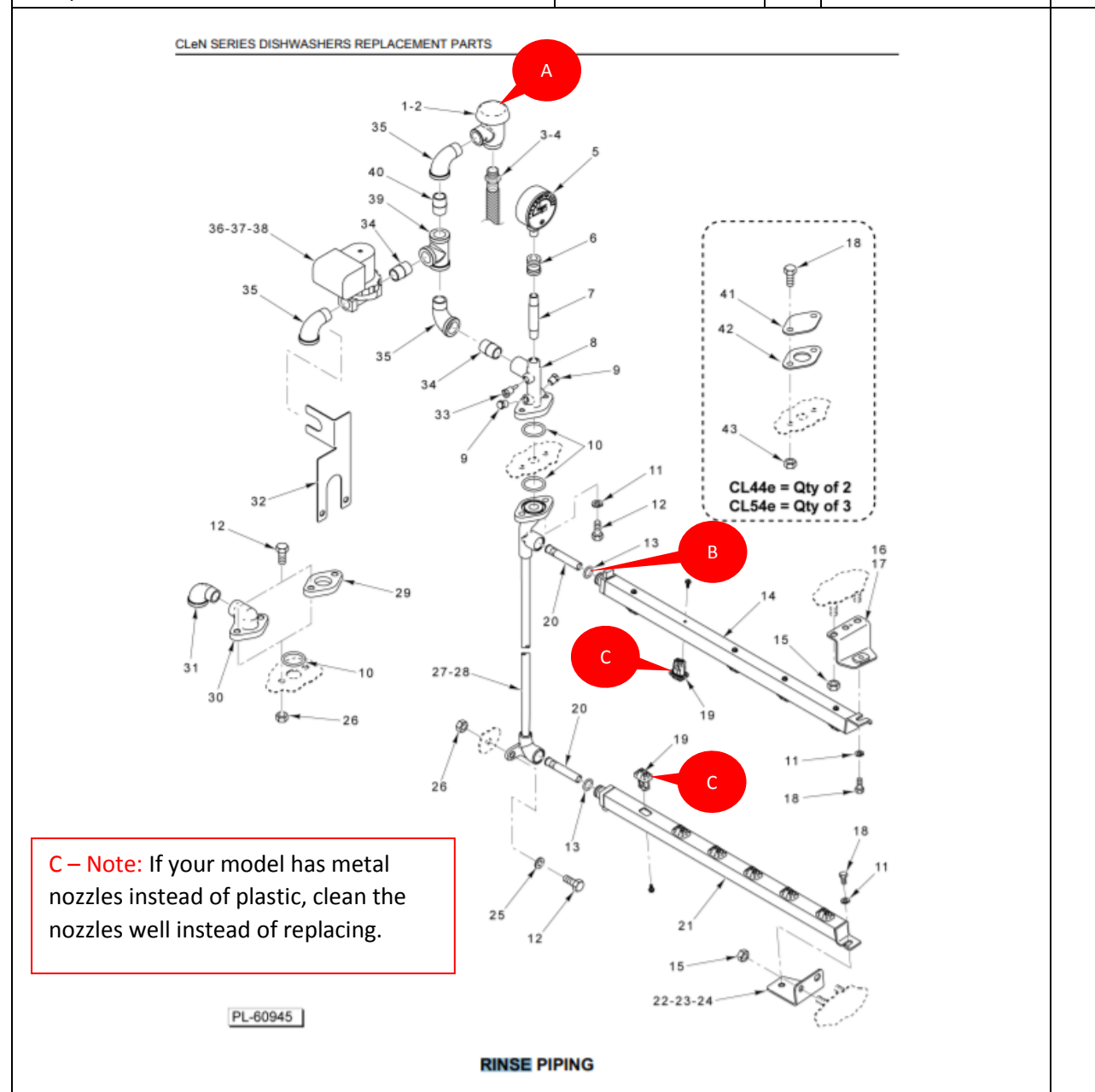

Drain System

✓ = PROCESS COMPLETED

Task	Part	Qty	Comments	<input type="checkbox"/>
A: Replace fill floats.	00-122674	3	C44A & C54A Only	<input type="checkbox"/>
		6	C64A Only	<input type="checkbox"/>
B: Replace standpipe O-Ring.	00-067500-00120	5	---	<input type="checkbox"/>
C: Replace O-Ring.	00-067500-00118	3	C64A Only	<input type="checkbox"/>

FILL & OUTSIDE RINSE PIPING

DRAIN UNIT (WASH/RINSE SECTION)

UPPER FLOAT SWITCH

LOWER FLOAT SWITCH

Position Magnets outward

Curtains (CLA)

✓ = PROCESS COMPLETED

Task	Part	Qty	Comments	<input type="checkbox"/>
Replace curtains.	---	---	---	<input type="checkbox"/>
Splash Short Curtain.	00-120151-00001	1	---	<input type="checkbox"/>
		3	C64A Only	<input type="checkbox"/>
Splash Standard Curtain.	00-271084	2	---	<input type="checkbox"/>
	---	4	C64A Only	<input type="checkbox"/>

SINGLE TANK MACHINES (C44A/AW AND C54A SERIES)

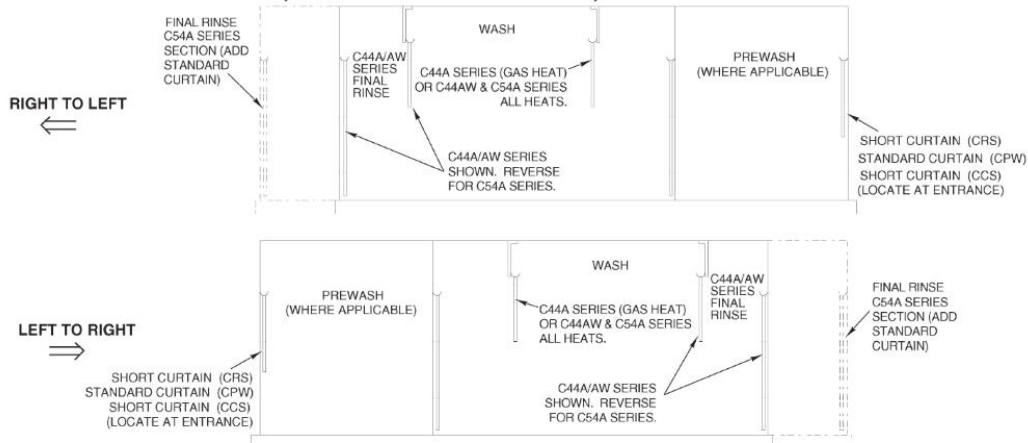

TWO TANK MACHINES (C64A SERIES)

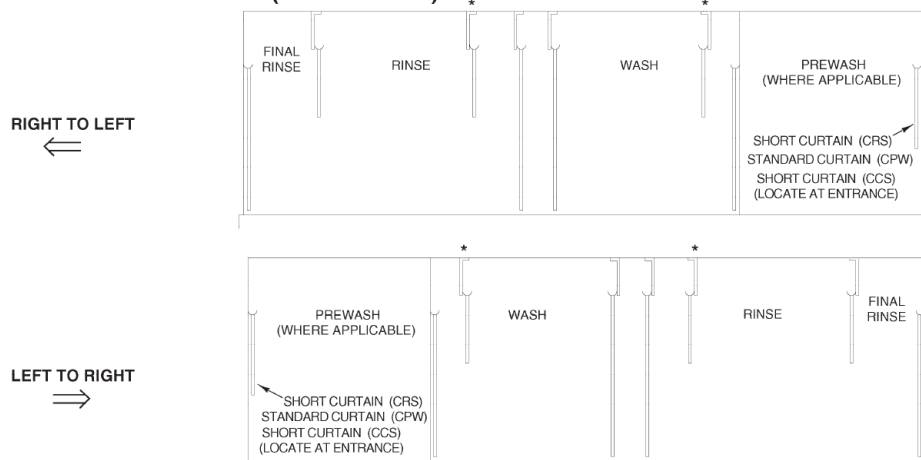

* 6 inches Higher Than Standard Models Only.