



Project _____
AIA # _____ SIS # _____
Item # _____ Quantity _____ C.S.I. Section 114000



FOODWASTE DISPOSER REPLACEMENT CONE ADAPTERS

FOR INSTALLATION OF HOBART DISPOSERS ON EXISTING CONES

FOODWASTE DISPOSER REPLACEMENT CONE ADAPTERS

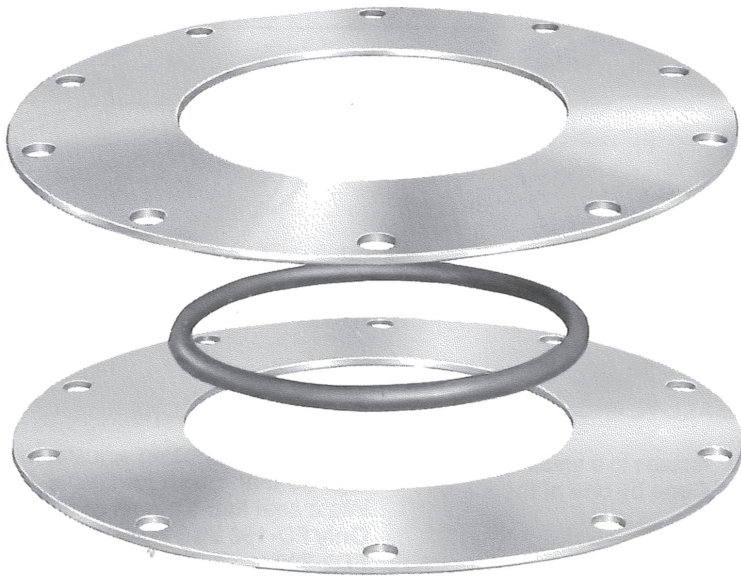

Approved by _____ Date _____ Approved by _____ Date _____

HOW TO REPLACE OLD FOODWASTE DISPOSERS

Each year, thousands of commercial foodwaste disposers reach the age and condition where it is more practical to replace than to maintain them.

Adapters are usually required to fit disposers to original cones (including sink or trough connections). In order to choose the correct adapter for replacement installation, follow the procedure below.

Procedure:

Step 1

Identify Cone type on chart below.

Step 2

Measure throat opening size of cone (inside diameter). (Dimension A)

A suggested method is to use two sticks or pencils. Insert them into the throat of the cone, sliding them apart until they touch the sides at the widest part of the throat.

Then remove and measure their extended length. (Figure 1)

Step 3

Measure bolt circle diameter (DISTANCE BETWEEN CENTER OF OPPOSITE BOLT HOLE). (Dimension B).

If old Disposer is still in place, measure with calipers or form one from stiff wire. Bend until ends touch center of opposite bolt heads. Remove and measure distance between ends. (Figure 2)

Step 4

When dimensions A & B and Cone Type have been determined, select proper adapter from list on facing page.

Important: Measure height of old disposer and check drain size. Compare to dimensions in specification sheet to make certain your new disposer will fit.

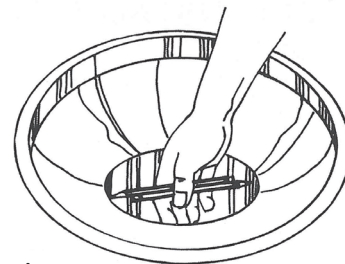

Figure 1

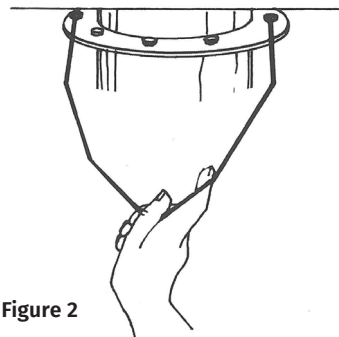
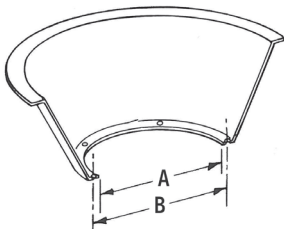

Figure 2

Type 1



Bowl Type Cone

The Disposer is bolted directly to a turned-in flange or a loose ring inside cone.

Type 2

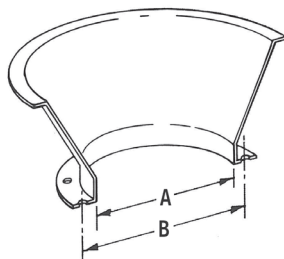

Cone w/Large Flange

The Disposer bolts directly to the flange on the bottom of this type Cone.

Type 3

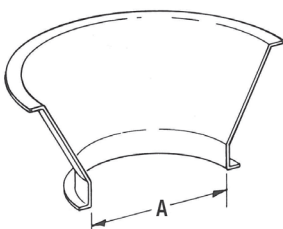

Cone w/Small Flange Lip

The Disposer fastens to a small lip on the bottom of the Cone by one of the following methods:

1. Two-piece Clamp Rings – spread and reassemble above cone lip – bolts fasten to Disposer.
2. Loose Collar Ring slips onto the Cone before the lip is rolled on the Cone. The Disposer bolts to the collar.
3. Molded or hose-type rubber connector fits over the Cone lip and is secured by means of hose clamp type connector.

Type 4

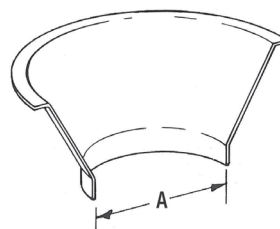

Sleeve Type Cone

Raise Disposer using adjustable support legs so that the Cone sleeve fits tightly into a seal in the mouth of the Disposer. **Only FD-150 thru FD-500, FD2-150 thru FD2-300, FD3-150 thru FD3-300 and FD4-150 thru FD4-500.** Disposers with adjustable legs can be used with this type Cone.

Type 5

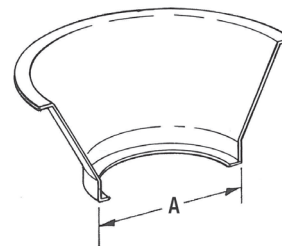

Sleeve Type Cone

Turned-in flange, against which a seal is compressed. **Only FD-150 thru FD-500, FD2-150 thru FD2-300, FD3-150 thru FD3-300 and FD4-150 thru FD4-500.** Disposers with adjustable legs can be used with this type Cone.



FOODWASTE DISPOSER REPLACEMENT CONE ADAPTERS

SIZING CHART

Cone Type	Dimension		Used By	Adapter Required	For Hobart Models	Special Instructions
	A	B				
1	4½	5½	Hobart, Kitchen Pig, Salvajor, Bus Boy	ML-31167	All	Reuse loose internal clamp ring, if present.
2	4½	5½	Waste King, Red Goat, In-Sink-Erator, National, Big Genie	ML-31159	All	None
2	6	6¾	Atomic	ML-31160	All	None
2	9	11⅝	Hobart	ML-31168	All	None
3	4½	—	In-Sink-Erator, Waste King, Toledo	ML-31159	All	None
3	6	—	In-Sink-Erator, Waste King, Toledo, Bus Boy	ML-31160	All	Remove Waste King, loosen collar, or push it up and out of the way.
3	8	—	In-Sink-Erator, Toledo	ML-31166	All	Reuse clamp ring mounting screws.
3	4⅝	—	FMC	ML-31169	All	None
3	5¼	—	FMC	ML-31170	All	None
3	6⅝	—	In-Sink-Erator, Toast-Master	ML-31171	All	None
4	4½	—	Red Goat	ML-31162	FD2-150 FD2-200 FD2-300 FD3-150 FD3-200 FD3-300 FD-500 FD4-150 FD4-200 FD4-300 FD4-500	None
4	6	—	Waste King	ML-31163		None
4	6½	—	Salvajor	ML-31164		None
4	6⅜	—	General Electric	ML-31165		None
5	5⅜	—	Hobart	ML-31161		None
4	7	—	Red Goat	None		Use Disposer legs to “jack-up” so cone sleeve is inserted in Disposer throat.
3	7	—	National, Big Genie, Toledo	None	All	None

Note: If disposer is installed in sink or trough, it will be connected to an adapter exactly like the cone connection.



FOODWASTE DISPOSER REPLACEMENT CONE ADAPTERS

STAINLESS STEEL ADAPTER KIT DESCRIPTIONS

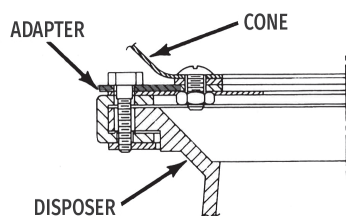
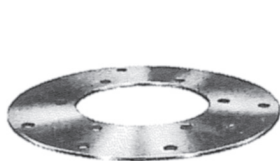

ADAPTER #ML-31167
Bolts directly to a Type #1 Cone.

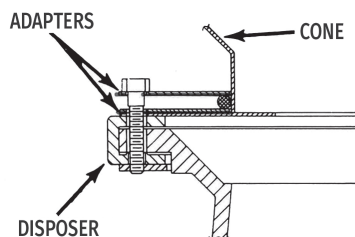
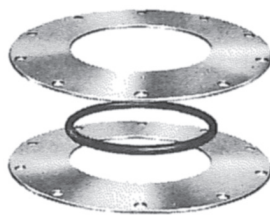

**ADAPTER #ML-31162, #ML-31163,
#ML-31164 and #ML-31165**
Use an "O" Ring to seal around the
sleeve of a Type #4 Cone.

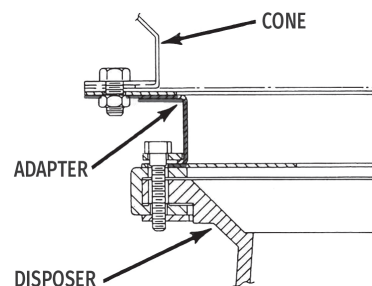

ADAPTER #ML-31166
Bolts directly to existing clamp ring
of Type #3 Cone. Reuse clamp ring
and screws already on the Cone.

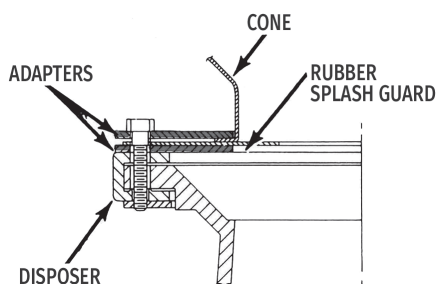

**ADAPTERS #ML-31159, #ML-31160,
#ML-31169, #ML-31170 and #ML-31171**
Clamp to flange of Type #2 or Type
#3 Cones. Rubber splash guard
between solid ring and split
ring. Use silicone seal to make it
permanent.

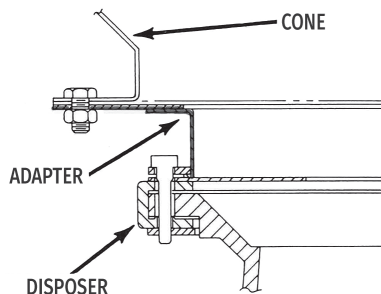

ADAPTER #ML-31168
Bolts directly to a Type #2 Cone.

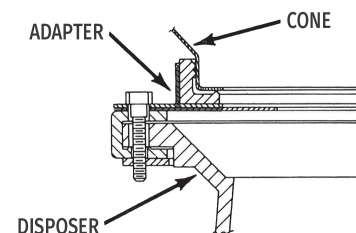

ADAPTER #ML-31161
Retains a special seal which is
compressed against a Type #5 Cone.
Note: Sealastic or similar silicone
gasket material should be used if
additional sealing is required when
adapting a new disposer to an
existing cone.